

**Note:**  
 The boundaries shown in **RED** are  
 the boundaries fixed from Plan No.979,  
 after superimposition.



**Reference**

- P** - Permanent Building.
- BS - Boundary Stone.
- CP - Concrete Post.
- Dn - Drain.
- Road(RDA)-Road (Road Development Authority).

**D.L.D.Y.WIJEWARDENA J.P..C.S.S.I.**  
 Residence & Office.  
 6/1 PARK ROAD,  
 HATTON.  
 Tel: 051-2222393 Fax: 051-2222324  
 077-6172028  
 e. mafididy\_wijewardena@yahoo.com

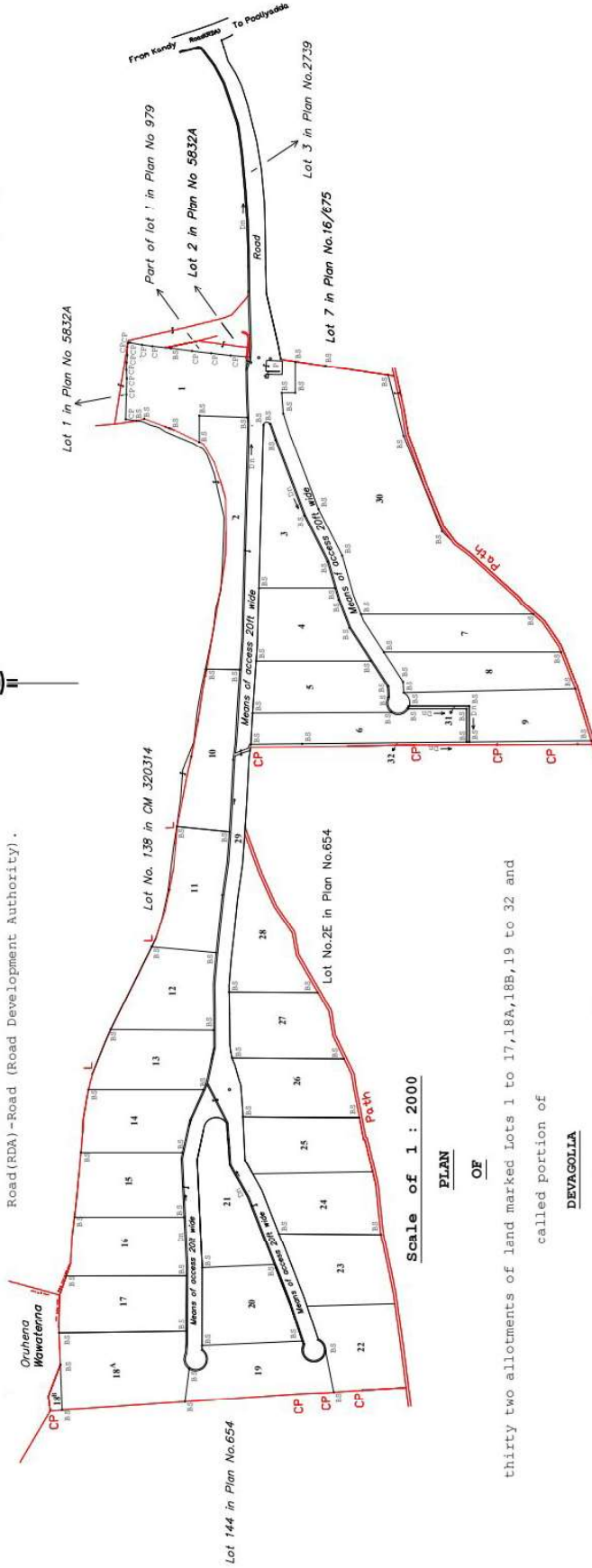

Scale of 1 : 2000

**PLAN**  
**OF**

thirty two allotments of land marked Lots 1 to 17,18A,18B,19 to 32 and  
 called portion of

**DEVAGOLLA**

being a re-survey,an amalgamation and sub-division  
 of Lots 1(part),2 to 30 in Plan No.979, dated 11-06-2018 by R.R.J.R.Jayakody L.S. & (See overleaf for the Schedule of Extents & Boundaries)  
 part of lot 1 in Plan No.5832A,dated 05-11-2016 by C.D.Adhetti L.S.

situated at Ampitiya  
 in Nehiniwela Grama Niladhari Division (No.962)  
 within the Pradesiya Sabha Limits of Pathahewaheta  
 in the Divisional Secretariat Area of Pathahewaheta

**KANDY DISTRICT**  
**CENTRAL PROVINCE**

For the use of the Local Authority

Surveyed on 27 June 2025

Registered Licensed Surveyor  
 (Regd: No. 19640502)

&  
 Court Commissioner

Date of Plan:XX-08-2025